

Go to www.vtechphones.com to register your product for enhanced warranty support and the latest Vtech product news.

DS6771-3

DECT 6.0 cordless telephone with BLUETOOTH® wireless technology



vtech

Abridged user's manual

Congratulations

On purchasing your new Vtech product. Before using this product, please read **Important safety instructions**.

This abridged user's manual provides you with basic installation and use instructions. A limited set of features are described in abbreviated form.

Please refer to the online User's manual for a full set of installation and operation instructions at www.vtechphones.com.



Telephones identified with this logo have reduced noise and interference when used with most T-coil equipped hearing aids and cochlear implants. The TIA-1093 Compliant Logo is a trademark of the Telecommunications Industry Association. Used under license.

The ENERGY STAR® program (www.energystar.gov) recognizes and encourages the use of products that save energy and help protect our environment. We are proud to mark this product with the ENERGY STAR® label indicating it meets the latest energy efficiency guidelines.

What's in the box

Your product package contains the following items. Save your sales receipt and original packaging in the event warranty service is necessary.

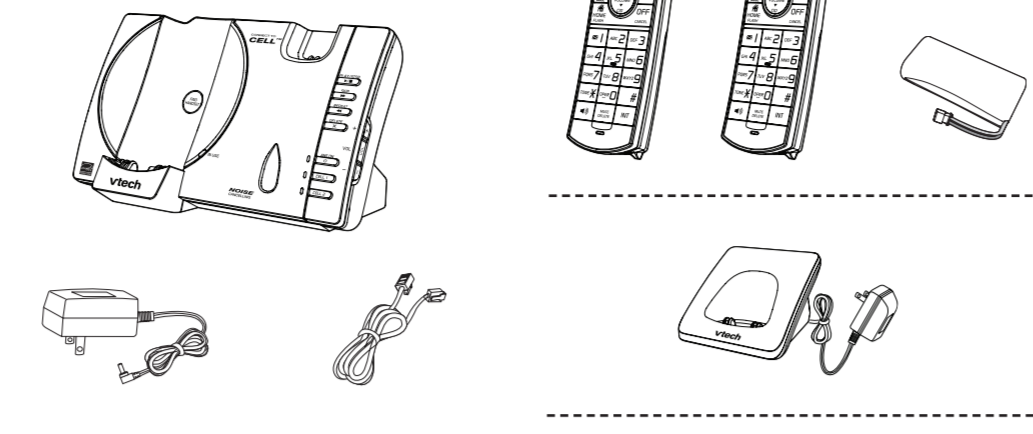

Telephone base overview

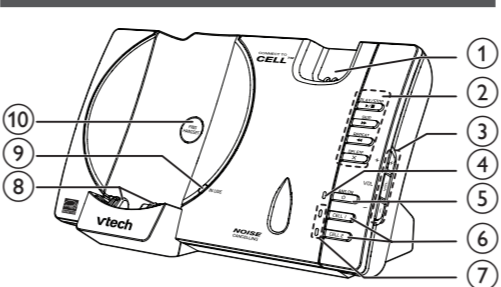

1 – Headset charging cradle

2 – ►/◄PLAY/STOP

- Press to play messages.
- Press to stop message playback.

►►/◄◄SKIP

- Press to skip to the next message.

◄◄/REPEAT

- Press to repeat a message.
- Press twice to play the previous message.

X/DELETE

- Press to delete the playing message.
- When the handset is not in use, press twice to delete all old messages.

3 – + /VOL- /

- Press to adjust the volume during message playback.
- Press to adjust the telephone base ringer volume when the handset is not in use.

4 – ◄/ANS ON light

- On when the answering system is on.

5 – ◄/ANS ON

- Press to turn the answering system on or off.

6 – CELL 1 and CELL 2

- Press to connect the paired cell Bluetooth device.
- Press and hold to add or replace a Bluetooth device.

7 – CELL 1 and CELL 2 lights

- On when the telephone base is paired and connected with a Bluetooth device.
- Flashes when the telephone base is in discoverable mode.

8 – Charging cradle

9 – IN USE light

- On when the handset or headset is in use, or the answering system is answering a call.
- Flashes when there is an incoming call, or another telephone sharing the same line is in use.

10 – FIND HANDSET

- Press to page all system handsets and headset.

Handset overview

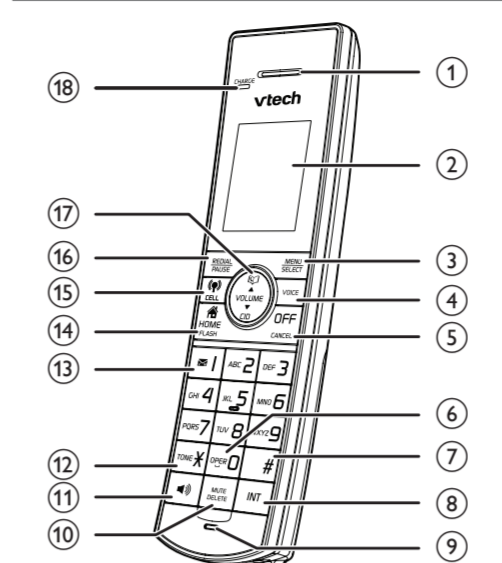

1 – Handset earpiece

2 – LCD display

- MENU/SELECT
- Show the menu.
- While in a menu, press to select an item, or save an entry or setting.

4 – VOICE

- Press to activate the voice-controlled application on your connected cell phone.

5 – OFF/CANCEL

- Hang up a call.
- Silence the ringer temporarily while the handset is ringing.
- Press and hold to erase the missed call indicator while the phone is not in use.

- Press to return to the previous menu; or press and hold to return to idle mode, without making changes.

6 – 0

- Press to add a space when entering names.

7 –

- Press repeatedly to show other dialing options when reviewing a caller ID log entry.

8 – INT

- Press to start an intercom conversation or transfer a call.

9 – Microphone

- Mute the microphone during a call.
- Delete digits or characters while using the dialing keys.
- Silence the ringer temporarily while the handset is ringing.

- Delete the displayed entry while reviewing the phonebook, caller ID log, call block list or redial list.

11 – ◄

- Make or answer a call using the handset speakerphone.
- During a call, press to switch between the speakerphone and the handset.

12 – X

- While you have set the dial mode to pulse and on a call, press to switch to tone dialing temporarily.

13 – 1

- Press repeatedly to add or remove 1 in front of the caller ID log entry before dialing or saving it to the phonebook.
- Press and hold to set or dial your voicemail number.

14 – ◄/HOME/FLASH

- Make or answer a home call.
- Answer an incoming home call when you hear a call waiting alert.

15 – ◄/CELL

- Make or answer a cell call.
- Answer an incoming cell call when you hear a call waiting alert.

16 – ◄/REDIAL/PAUSE

- Press repeatedly to review the redial list.
- Press and hold to insert a dialing pause while entering a number.

17 – VOLUME / ▲ / ▼

- Review the phonebook when the handset is not in use.
- Increase the listening volume during a call.
- Scroll up while in a menu, or in the phonebook, caller ID log, call block list or redial list.
- Move the cursor to the right when entering numbers or names.
- Decrease the listening volume during a call.
- Scroll down while in a menu, or in the phonebook, caller ID log, call block list or redial list.
- Move the cursor to the left when entering numbers or names.

18 – CHARGE light

- On when the handset is charging.

Headset overview

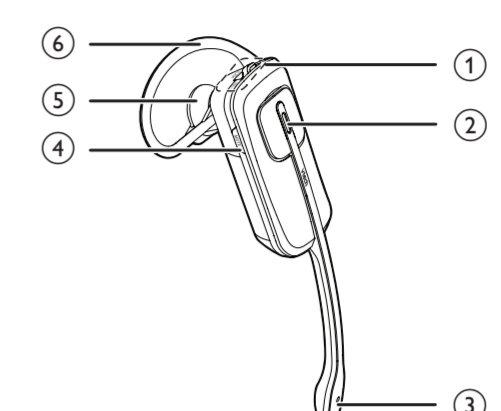

1 – VOL+

- Increase the headset volume.

VOL-

- Decrease the headset volume.

Flash

- While on a call, press and hold to answer an incoming call when you receive a call waiting alert.

2 – ON/OFF light

- On when the headset is charging.

ON/OFF key

- Press to answer or end a call.

3 – Microphone

4 – MUTE

- Press to activate the voice-controlled application on your connected cell phone when idle.
- Mute the microphone during a call.
- When there is an incoming call, press to silence the ringer in the earpiece temporarily.

5 – Earpiece

6 – Earhook

Charger overview

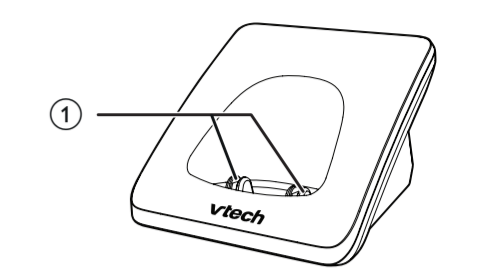

1 – Charging pole

Display icons overview

	The battery icon flashes when the battery is low and needs charging.
	The battery icon animates when the battery is charging.
	The battery icon becomes solid when the battery is fully charged.
	The ECO mode activates automatically to reduce power consumption when the handset is within range from the telephone base.
	There are new voicemail received from your telephone service provider.
	On when the home line is in use or there is an incoming home call. Flashes when there is an incoming home waiting call.
	There are Bluetooth devices connected on the cell devices list.
	On when the cell line is in use or there is an incoming cell call. Flashes when there is an incoming cell waiting call.
	There are new caller ID log entries.
	The answering system is turned on.
	The handset ringer is off.
	The message number currently playing and total number of new/old messages recorded.

Connect

You can choose to connect the telephone base for desktop usage.

NOTES

- Use only the adapters provided.
- Even if you do not subscribe to any conventional telephone service, you can pair a Bluetooth enabled cell phone to your telephone base (see **Bluetooth**), and use the cell line alone without plugging in a telephone line cord.

TIP

- If you subscribe to digital subscriber line (DSL) high-speed Internet service through your telephone line, make sure you install a DSL filter (not included) between the telephone line cord and telephone wall jack. Contact your DSL service provider for more information.

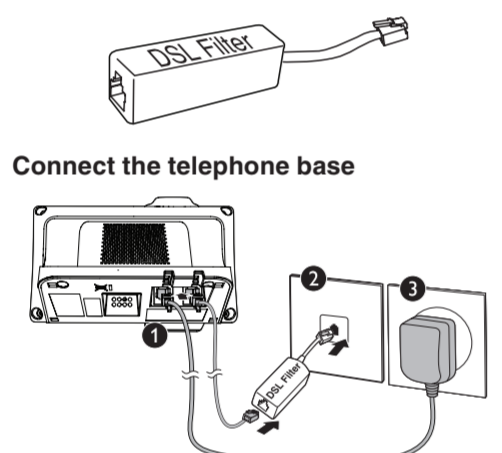

Connect the charger

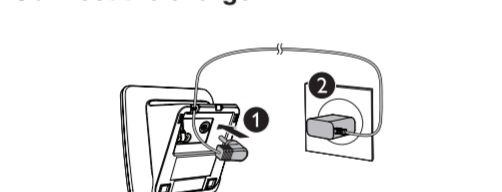

Install the battery

Install the handset battery as shown below.

NOTES

- Use only supplied battery.
- If the handset will not be used for a long time, disconnect and remove the battery to prevent possible leakage.

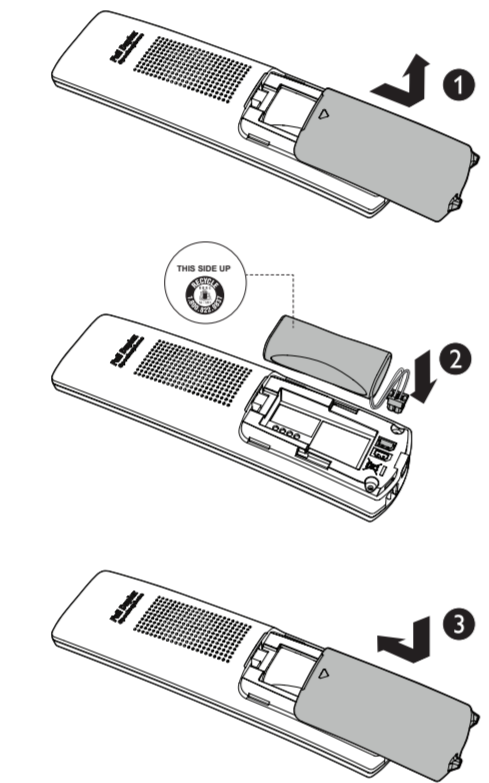

Install the headset battery

Install the headset battery as shown below.

NOTE

- Use only supplied battery.

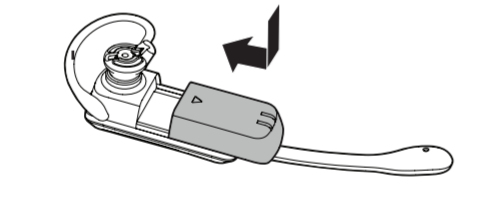

Check the battery level

After you have installed the battery, check the battery level on the handset screen.

- If the battery icon is or , then go to **Before use** section to set the date and time, and set the answering system through voice guide.
- If the screen is blank, or flashes, then the battery needs to be charged. Go to **Charge the battery** section before you do any setting or operation.

Charge the battery

Place the handset in the telephone base or the charger to charge.

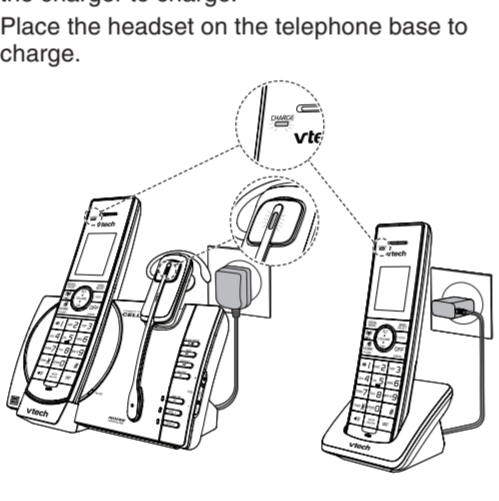

Once you have installed the battery, the handset LCD display indicates the battery status (see the table below).

NOTES

- Press **CANCEL** or place the handset in the telephone base or charger will bypass the set date and time, and voice guide.
- For best performance, keep the handset in the telephone base or charger when not in use. Place the handset on the telephone base when not in use.
- The handset battery is fully charged after 12 hours of continuous charging. The handset battery is fully charged after three hours of continuous charging.
- If you place the handset in the telephone base or the charger without plugging in the battery, the screen displays **No battery**.

Battery indicators	Battery status	Action
The screen is blank, or shows Put in charger and flashes.	The battery has no charge or very little charge. The handset cannot be used.	Charge without interruption (at least 30 minutes).
The screen shows Low battery and flashes.	The battery has enough charge to be used for a short time.	Charge without interruption (at least 30 minutes).
The screen shows HANSET X .	The battery is charged.	To keep the battery charged, place it in the telephone base or charger when not in use.

To manually set the date and time and the answering system, refer to **Configure your telephone** and **Set your built-in answering system** sections.

To manually initiate the voice guide, refer to **Voice guide** under **Set your built-in answering system** section.

Position the handset

There are four earbuds and four earhooks provided. One earbud and one earhook have been attached to the handset.

You can choose a suitable size of earbud, earhook and an appropriate way to position your headset.

Replace the pre-installed earbud and earhook:

- Hold both sides of the earbud. Twist and pull the earbud until it separates from the earpiece.



- Rotate the earhook to vertical direction and then pull the earhook until it separates from the handset.



- Attach an earhook, and then a suitable earbud to the handset until they fit into place.

To wear on the right ear:



To wear on the left ear:

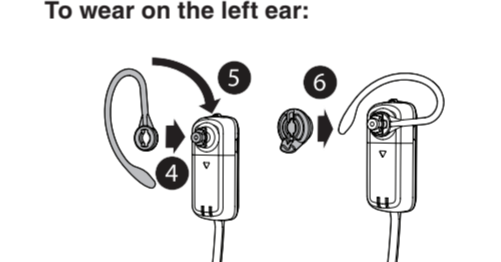

- Wrap the earhook with the sponge.

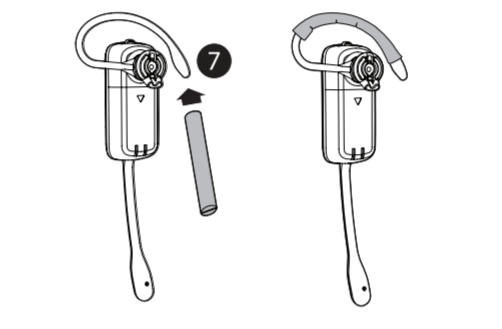

Adjust the handset to wear on the ear:

- Hook the handset on your ear. Adjust the angle of the handset until the microphone is pointing towards your mouth. Firmly grip the handset with one hand whenever adjusting the handset microphone up or down.

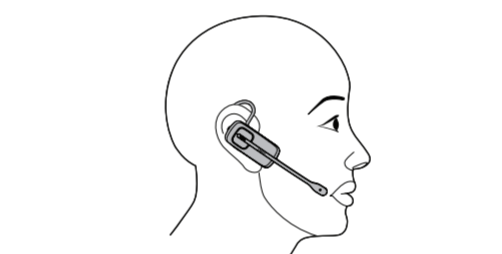

Over the head band

To attach the head band to the headset:

- Refer to Steps 1 and 2 in **Replace the pre-installed earbud and earhook** section to remove the earbud and earhook.
- Attach the handset to the headband.

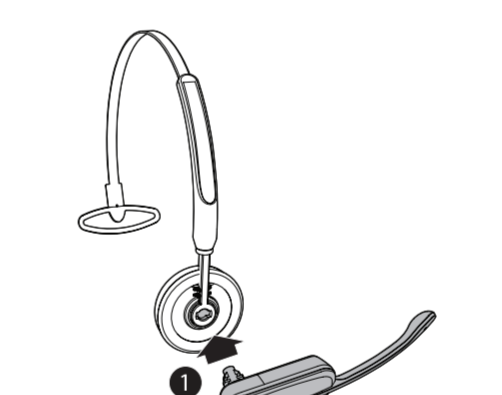

- Rotate the headset to vertical direction until it clicks into place.

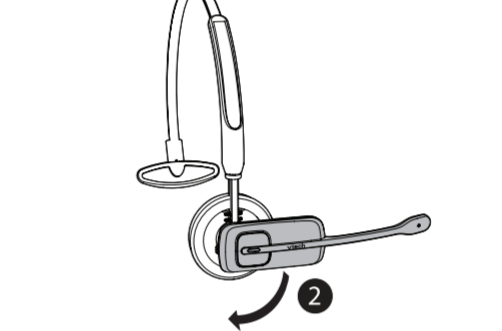

- Adjust the head band to fit your head. Adjust and rotate the angle of the headset until the microphone is pointing towards your mouth.

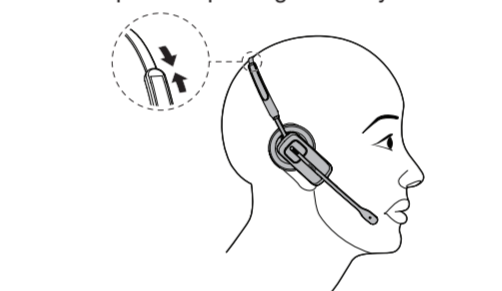

To remove the head band from the headset:

- Hold the headset with one hand and the head band with your other hand.
- Rotate the headset to horizontal direction and the pull the handset until it separates from the head band.

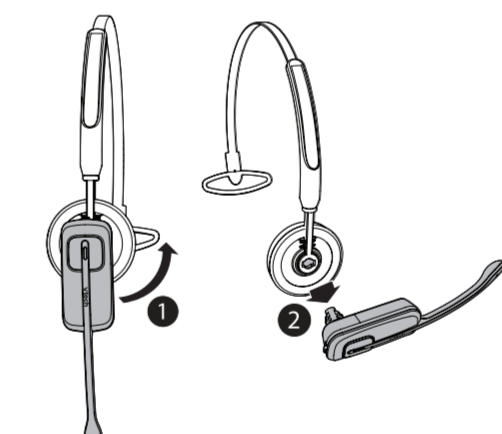

Before use

After you install your telephone or power returns following a power outage and battery depletion, the handset will prompt you to set the date and time, and the answering system through voice guide.

Set date and time

NOTE

- Make sure you set the date and time including the year correctly; otherwise the answering system does not announce the correct day of the week for your recorded messages time stamp.

- Use the dialing keys (0-9) to enter the month (MM), date (DD) and year (YY). Then press **SELECT**.
- Use the dialing keys (0-9) to enter the hour (HH) and minute (MM). Then press **▼** or **▲** to choose AM or PM.
- Press **SELECT** to save.

After the setting for the date and time, the handset will display **Voice guide to...** and set up **Ans sys?** alternatively.

Set answering system through voice guide

This feature assists you to do the basic setup of the answering system. You can follow the voice guide to record your own announcement, set the number of rings and the message alert tone.

- Press **SELECT** to start the voice guide for the answering system setup. You hear the voice prompt "Hello! This voice guide will assist you with the basic setup of your answering system."
- Setup your answering system by inputting the designated numbers as instructed in the voice guide.

Check for dial tone: Press **◄/HOME**. If you hear a dial tone, the installation is successful.

If you do not hear a dial tone:

- Make sure the installation procedures described above are properly done.
- It may be a wiring problem. If you have changed your telephone service to digital service from a cable company or a VoIP service provider, the telephone line may need to be rewired to allow all existing telephone jacks to work. Contact your cable/VoIP service provider for more information.

Operating range

This cordless telephone operates with the maximum power allowed by the Federal Communications Commission (FCC). Even so, this handset and telephone base can communicate over only a certain distance - which can vary with the locations of the telephone base and handset, the weather, and the layout of your home or office. When the handset is out of range, the handset displays **Out of range** or **no pwr at base** alternately.

If there is a call while the handset is out of range, it may not ring, or if it does ring, the call may not connect well when you press **◄/HOME** or **◄/CELL**. Move closer to the telephone base, and then press **◄/HOME** or **◄/CELL** to answer the call. If the handset moves out of range during a telephone conversation, there may be interference. To improve reception, move closer to the telephone base.

Bluetooth

NOTE

- Make sure your cell phone has a good cell reception near the telephone base.

To use a Bluetooth enabled cell phone or headset with your DS6771, you must first pair and connect your Bluetooth cell phone or headset with the telephone base.



Bluetooth wireless technology operates within a short range (a maximum of approximately 15 feet). When you pair a Bluetooth cell phone to the telephone base, place your Bluetooth cell phone closer to the telephone base to maintain sufficient signal strength.

NOTES

- For optimal performance, place your cell phone next to the telephone base while using the cell line.
- To avoid interference from other electronic devices, place your telephone base far away from devices such as baby monitors, wireless routers, microwaves and computers.

Pair and connect your Bluetooth enabled cell phone

- Enable a slot to pair the cell phone. Press and hold **CELL 1** or **CELL 2** on the telephone base until you hear a confirmation tone, and the **CELL 1** or **CELL 2** light flashes.
- Turn on the Bluetooth feature of your cell phone. Once your cell phone finds your Vtech phone (Vtech DS6771), press appropriate key on your cell phone to continue the pairing process.
- Your cell phone may prompt you to enter the PIN of the telephone base. The default PIN of the telephone base is **0000**.

When the cell phone is connected to the telephone base, the corresponding status icon (or) displays on handsets. The corresponding device light (**CELL 1** or **CELL 2**) turns on.

If the pairing fails, turn off the Bluetooth feature on your cell phone and on the DS6771 by pressing **CELL 1** or **CELL 2**. Then repeat the steps above to pair and connect again. In some cases, it may take you a few attempts to complete the pairing process.

Pair and connect your Bluetooth enabled headset

- Press **MENU** when the handset is not in use.
- Press **▼** or **▲** to scroll to **Bluetooth**, and then press **SELECT**.
- Press **▼** or **▲** to scroll to **Add BT headset**, and then press **SELECT**. The screen displays **Search headset...**
- Set your headset to discoverable mode. Once your handset finds your headset, press **SELECT**.
 - Enter the PIN of your headset if required. The PIN for most Bluetooth devices is **0000** (refer to the user's manual of your headset), and then press **SELECT**.

When the headset is successfully paired and connected to the telephone base, the icon displays on handsets. The **CELL 2** light turns on.

VTech Connect to Cell™ application

This application helps you integrate your Android phones with your DS6771

Intercom

Use the intercom features for conversations between two devices.

- Press **INT** on your handset when not in use. Use the dialing keys to enter a destination device number.
- To answer the intercom call, press **↵/HOME**, **↵/CELL**, **⏏**, or any dialing key on the destination handset, or press **ON/OFF** key on the handset.
- To end the intercom call, press **OFF** or place the handset back in the telephone base or charger, or press **ON/OFF** key on the handset.

Answer an incoming call during an intercom call

If you receive an incoming call during an intercom call, there is an alert tone.

- Using a handset:**
 - To answer a home call, press **↵/HOME**. The intercom call ends automatically.
 - To end the intercom call without answering the outside call, press **OFF**. The intercom call ends and the telephone continues to ring.
- To answer a cell call, press **OFF** to end the intercom call. The telephone continues to ring. Then press **↵/CELL**.

Using a handset:

- Press **ON/OFF** key to end the intercom call. The telephone continues to ring. Press **ON/OFF** key again to answer the home call.

Call transfer using intercom

While on an outside call, you can use the intercom feature to transfer the call from one device to another.

- Press **INT** on your handset during a call. The current call is put on hold.
- Use the dialing keys to enter a destination device number.
- To answer the intercom call, press **↵/HOME**, **↵/CELL**, **⏏**, or any dialing key on the destination handset, or press **ON/OFF** key on the destination headset. You can now have a private conversation before transferring the call.
- To transfer the call, press **OFF** on the initiating handset or place the initiating handset back in the telephone base or charger.

- To end the intercom call, press **OFF** on the destination handset or place the destination handset back in the telephone base or charger, or press **ON/OFF** key on the destination headset.

Phonebook

The phonebook can store up to 1000 entries, which are shared by all handsets. Each entry may consist of a telephone number up to 30 digits, and a name up to 15 characters.

Add a phonebook entry

- Press **MENU** when the handset is not in use.
- Scroll to **Phonebook** then press **SELECT**.
- Press **SELECT** again to choose **Add new entry**.
- Use the dialing keys to enter the number (up to 30 digits).
- Press **SELECT** to move to the name.
- Use the dialing keys to enter the name (up to 15 characters). Additional key presses show other characters of that particular key.
- Press **SELECT** to save.

While entering numbers and names, you can:

- Press **DELETE** to erase a digit or character.
- Press and hold **DELETE** to erase the entire entry.
- Press **▼** or **▲** to move the cursor to the left or right.
- Press and hold **PAUSE** to insert a dialing cause (for entering phone numbers only).
- Press ***→** to add **X** (appears) or **#** to add **#** (appears) (for entering phone numbers only).
- Press **0** to add a space (for entering names only).

Review the phonebook

Entries are sorted alphabetically.

- Press **↻** when the handset is not in use.
- Scroll to browse through the phonebook, or use the dialing keys to start a name search (you can enter up to 3 characters for the search).
- When the desired entry appears, press **↵/HOME** or **⏏** to dial.

Delete a phonebook entry:

- When the desired entry displays, press **DELETE**.
- When the screen displays **Delete entry?**, press **SELECT**.

Delete all phonebook entries:

- Press **MENU** when the handset is not in use.
- Scroll to **Phonebook**, and then press **SELECT**.
- Scroll to **Delete all**, and then press **SELECT**.
- When the screen displays **Delete all?**, press **SELECT**.

Edit a phonebook entry

- When the desired entry displays, press **SELECT**.
- Use the dialing keys to edit the number, and then press **SELECT**.
- Use the dialing keys to edit the name, and then press **SELECT** to save.

Dial a phonebook entry

When the desired entry appears, press

- ↵/HOME** or **⏏** to dial.

Caller ID

If you subscribe to caller ID service, information about each caller appears after the first or second ring. If you answer a call before the caller information appears on the screen, it will not be saved in the caller ID log.

The caller ID log stores up to 50 entries. Each entry has up to 24 digits for the phone number and 15 characters for the name.

If the telephone number has more than 15 digits, only the last 15 digits appear. If the name has more than 15 characters, only the first 15 characters are shown and saved in the caller ID log.

Review a caller ID log entry

- Press **CID** when the handset is not in use.
- Scroll to browse through the caller ID log.

Call block

When there are calls that have not been reviewed in the caller ID log, the handset displays **XX missed calls**.

Each time you review a caller ID log entry marks *NEW*, the number of missed calls decreases by one.

When you have reviewed all the missed calls, the missed call indicator no longer displays. If you do not want to review the missed calls one by one, press and hold **CANCEL** on the idle handset to erase the missed call indicator. All the entries are then considered old.

Dial a caller ID log entry

- When the desired entry appears, press **↵/HOME** or **⏏** on the handset to dial.

Save a caller ID log entry to the phonebook

- When the desired caller ID log entry displays, press **SELECT**.
- Scroll to **To Phonebook** then press **SELECT**.
- Use the dialing keys to modify the number if necessary, and then press **SELECT**.
- Use the dialing keys to enter the name, and then press **SELECT** to save.

Delete a caller ID log entry

- When the desired caller ID log entry displays, press **DELETE**.

Delete all caller ID log entries

- Press **MENU** when the handset is not in use. Scroll to **Caller ID log** and then press **SELECT**. Scroll to **Delete all** and then press **SELECT** twice.

Review call block list

- Press **MENU** when the handset is not in use.

- Scroll to **Call block**, and then press **SELECT**.

- Scroll to **Block list**, and then press **SELECT**.

- Press **SELECT** to choose **Review**.

- When the desired entry displays, press **SELECT**.
- Use the dialing keys to edit the number, and then press **SELECT**.
- Use the dialing keys to edit the name, and then press **SELECT** to save.

Save a caller ID log entry to call block list

- When the desired entry displays, press **SELECT**.

- Scroll to **To Call block** then press **SELECT**.

- Use the dialing keys to modify the number if necessary, and then press **SELECT**.

- Use the dialing keys to enter the name, and then press **SELECT** to save.

Delete a call block list entry

- When the desired call block list entry displays, press **DELETE** on the handset.

Mute first ring

Your telephone rings once for blocked calls.

You can choose to mute the first ring for all incoming calls, so that there will be no ring for blocked calls. By default, the first ring is set to **On**.

- Press **MENU** when the handset is not in use.
- Press **7464#** on the handset.

- Scroll to choose **First ring:On** to keep the first ring, or **First ring:Off** to mute the first ring.
- Press **SELECT** to save.

- If you have muted the first ring, you will hear one ring less before the answering system and voicemail answer the incoming calls.

Sound settings

Key tone

- You can choose from different ringer tones.
 - Press **MENU** when the handset is not in use.
 - Scroll to **Settings**, and then press **SELECT**.
 - Scroll to choose **Key tone**, and then press **SELECT**.
 - Scroll to choose **On or Off**, and then press **SELECT** to save.

Delete the announcement

- Press **MENU** when the handset is not in use.
- Scroll to **Answering sys** and then press **SELECT** twice.
- The handset announces, *“To play, press 2. To record, press 7.”*
- Press **3** to delete your own recorded announcement.

Set number of rings

You can set the answering system to answer an incoming call after 2, 3, 4, 5 or 6 rings; or toll saver. If you choose toll saver, the answering system answers a call after 2 rings when you have new messages, or after 4 rings when you have no new messages.

- Press **MENU** when the handset is not in use.
- Scroll to **Answering sys** then press **SELECT**.
- Scroll to **Ans sys setup** then press **SELECT**.
- Scroll to **# of rings** then press **SELECT**.
- Scroll to choose **2, 3, 4, 5, 6 or Toll Saver**.
- Press **SELECT** to save and you hear a confirmation tone.

ⓄNOTE

If you have muted the first ring, you will hear one ring less before the answering system answers the incoming calls.

Message alert tone

When the message alert tone is set to on, and there is at least one new message, the telephone base flashes and the message alert tone is preset to off.

- Press **MENU** when the handset is not in use.
- Scroll to **Answering sys** then press **SELECT**.
- Scroll to **Ans sys setup** then press **SELECT**.
- Scroll to **Msg alert tone** then press **SELECT**.
- Scroll to choose **On or Off**.
- Press **SELECT** to save and you hear a confirmation tone.

Voice guide

This feature is an alternative way for you to do the basic setup of the answering system. You can follow the voice guide to record your own announcement, set the number of rings and the message alert tone.

- Press **MENU** when the handset is not in use.
- Scroll to **Answering sys**, and then press **SELECT**.
- Scroll to **Voice guide**, and then press **SELECT**. You hear the voice prompt *“Hello!”*. This voice guide will assist you with the *basic setup of your answering system*.
 - Setup your answering system by inputting designated numbers as instructed in the voice guide.

Use your built-in answering system

New message indication

When there are new answering system messages, The handset displays **XX new messages** and the message window on the telephone base flashes.

Message playback

To playback messages at the telephone base:

- Press **↵/PLAY** when the handset is not in use.

Options during playback:

- Press **−/VOL+** to adjust the speaker volume.
- Press **↵/SKIP** to skip to the next message.
- Press **↵/REPEAT** to repeat the message currently playing. Press **↵/REPEAT** twice to listen to the previous message.
- Press **X/DELETE** to delete the playing message. The system advances to the next message.
- Press **↵/STOP** to stop.

To playback messages at the handset:

- Press **MENU** to choose **Play messages**. Press **SELECT**.

Options during playback:

- Press **VOLUME/▼** or **VOLUME/▲** to adjust the message playback volume.
- Press **▶** to skip to the next message.
- Press **▶** 4 to repeat the message. Press 4 twice to hear the previous message.
- Press **3** to delete the playing message.
- Press **OFF** to stop the playback.
- Press **⏏** to switch between speakerphone mode and handset mode.

Delete all old messages

To delete all old messages at the telephone base:

Press **X/DELETE** twice when the handset is not in use.

To delete all old messages on a handset:

- Press **MENU** when the handset is not in use.
- Scroll to **Answering sys**, and then press **SELECT**.
- Scroll to **Delete all old**, and then press **SELECT** twice. You hear a confirmation tone.

Remote access

A two-digit security code is required to access the answering system remotely from any touch-tone telephone. The preset code is **19**. You can set the code from **00 to 99**.

- Dial your telephone number from any touch-tone telephone.
- When the system plays your announcement, enter the two-digit security code.
- You can enter one of the following remote commands.

Command	Description
1	Play all messages.
2	Play new messages.
3	Delete the current message (during playback).
33	Delete all old messages.
4	Repeat the current message (during playback).
5	Stop.
*5	Hear a list of remote commands.

6	Skip to the next message (during playback).
*7	Record a new announcement.
8	End the call.
0	Turn the answering system on or off.

Retrieve voicemail from telephone service

Voicemail is a feature available from most telephone service providers. It may be included with your telephone service, or may be optional. Fees may apply.

Retrieve voicemail

When you received a voicemail, the handset displays **Ⓞ** and **New voicemail**. To retrieve, you typically dial an access number provided by your telephone service provider, and then enter a security code. Contact your telephone service provider for instructions on how to configure the voicemail settings and listen to messages.

Set your voicemail number

You can save your access number on each handset for easy access to your voicemail. After you save the voicemail number, you can press and hold **Ⓞ** to retrieve voicemail.

- Press **MENU** when the handset is not in use.
- Scroll to **Answering sys** then press **SELECT**.
- Scroll to **Ans sys setup** then press **SELECT**.
- Scroll to **Retrieve code**, and then press **SELECT**.
- Use the dialing keys to enter a two-digit number.
- Press **SELECT** to a desired two-digit number.
- Press **SELECT** to save and you hear a confirmation tone.

Use the built-in answering system and voicemail service

You can use your answering system and voicemail service together by setting your answering system to answer before voicemail service answers as described below. To learn how to program your voicemail settings, contact your telephone service provider. If you are on a call, or if the answering system is busy recording a message and you receive another call, the second caller can leave a voicemail message.

Set your answering system to answer calls at least two rings earlier than your voicemail service is set to answer. For example, if your voicemail service answers after six rings, set your answering system to answer after four rings. Some voicemail service providers may program the delay before answering calls in seconds instead of rings. In this case, allow six seconds per ring when determining the appropriate setting.

Other limitations

This warranty is the complete and exclusive agreement between you and VTech. It supersedes all other written or oral communications related to this Product. VTech provides no other warranties for this Product. The warranty exclusively describes all of VTech’s responsibilities regarding the Product. There are no other express warranties. No one is authorized to make modifications to this limited warranty and you should not rely on any such modification.

State/Provincial Law Rights: This warranty gives you protection under the Product operating instructions. This warranty may vary from state to state or province to province.

Limitations: Implied warranties, including those of fitness for a particular purpose and merchantability (an unwritten warranty that the Product is fit for ordinary use) are limited to one year from the date of purchase. Some states/provinces do not allow limitations on how long an implied warranty lasts, so the above limitation may not apply to you. In no event shall VTech be liable for any indirect, special, incidental, consequential, or similar damages (including, but not limited to lost profits or revenue, the risk of loss or damage during transport and transportation and are responsible for delivery or handling charges incurred in the transport of the Product(s) to the service location. VTech will return repaired or replaced Product under this limited warranty. Transportation, delivery or handling charges are prepaid. VTech assumes no risk for damage or loss of the Product in transit. If the Product failure is not covered by this limited warranty, or proof of purchase does not meet the terms of this limited warranty, VTech will notify you and will request that you authorize the cost of repair prior to any further repair activity. You must pay for the cost of repair and return shipping costs for the repair of Products that are not covered by this limited warranty.

Please retain your original sales receipt as proof of purchase.

Technical specifications	
Transmit frequency	DECT frequency: 1921.535-1928.448 MHz <p>Bluetooth frequency: 2402.000-2480.000 MHz</p>
Channels	DECT: 5 <p>Bluetooth: 79</p>
Nominal effective range	Maximum power allowed by FCC and IC. Actual operating range may vary according to environmental conditions at the time of use.
Power requirements	Handset: 2.4V Ni-MH battery <p>Telephone base: Output #1: 6V DC @ 450mA; Output #2: 6V DC @ 300mA <p>Charger: 6V DC @ 400mA</p></p>
Memory	Phonebook: 1000 memory locations (shared between home and call lines); up to 30 digits and 15 characters <p>Caller ID log: 50 memory locations; up to 24 digits and 15 characters <p>Call block: 20 entries</p></p>

Ringer tone

You can choose from different ringer tones.

- Press **MENU** when the handset is not in use.
- Scroll to **Ringers**, and then press **SELECT**.
- Scroll to choose **Home ringtone** or **Cell ringtone**, and then press **SELECT**.
- Scroll to sample each ringer tone, and then press **SELECT** to save.

ⓄNOTE

- If you turn off the ringer volume, you will not hear ringer tone samples.

Handset ringer volume

You can adjust the ringer volume level, or turn the ringer off.

- Press **MENU** when the handset is not in use.
- Scroll to **Ringers**, and then press **SELECT**.
- Scroll to choose **Home volume** or **Cell volume**, and then press **SELECT**.
- Scroll to adjust the volume, and then press **SELECT** to save.

ⓄNOTE

- If the handset ringer volume is set to off, that handset is silenced for all incoming calls except paging tone.

Telephone base ringer volume

You can adjust the telephone base volume level by pressing **−/VOL+** on the side of the telephone base when idle.

Temporary ringer silencing

When the telephone is ringing, you can temporarily silence the ringer of the handset without disconnecting the call. The next call rings normally at the preset volume.

- Press **OFF** or **MUTE** on the handset. The handset displays **Ⓞ**.

About answering system and voicemail service

For message recording, your telephone has a built-in answering system, and it also support voicemail service offered by your telephone service provider (subscription is required, and fee may apply).

The main differences between them are:

Category	Built-in answering system	Voicemail from telephone service
Storage	Messages are stored in the telephone base.	Messages are stored in a server or system provided by your telephone service.
	Your messages will not be deleted automatically. You have to delete your messages manually.	Your messages may be automatically deleted after a period of time. Contact your telephone service provider for more details.
Method to retrieve messages	When you received new messages, handset displays XX new messages and the message window on the telephone base flashes.	When you received new messages, the handset displays Ⓞ and New voicemail .
	To retrieve messages, usually there are two ways: <ul style="list-style-type: none">Press ▶ on the telephone base; Access remotely with an access code.	To retrieve messages, you need an access number and/or a passcode provided by your telephone service provider.

Set your built-in answering system

Your answering system has various features, read below for the basic settings.

The answering system can record and store up to 99 messages. Each message can be up to three minutes in length. The total storage capacity for the announcement, messages and memos is approximately 23 minutes. The actual recording time depends on individual message characteristics.

Your answering system allows you to set your announcement, to save and delete messages, activate call screening, to set number of rings before pick up, and to access remotely.

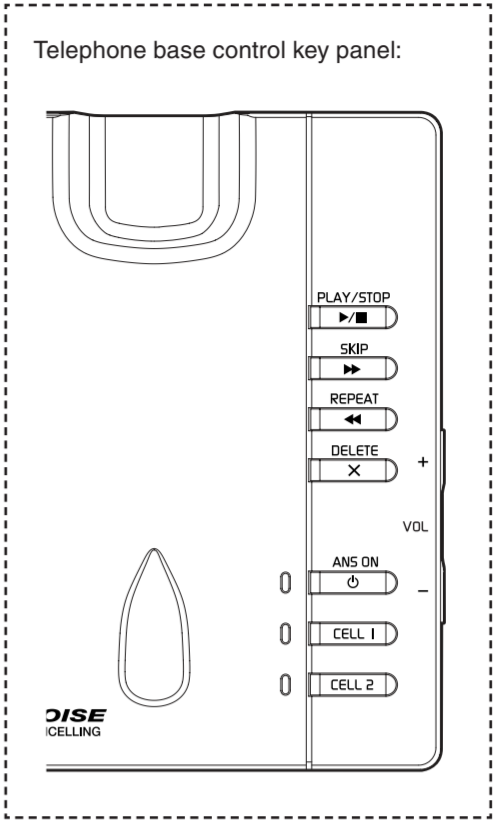

Turn the answering system on or off:

The answering system must be turned on to answer and record messages.

To turn on or off with the telephone base:

- Press **↵/ANS ON** on the telephone base to turn the built-in answering system on or off.

To turn on or off with the handset:

- Press **MENU** when the handset is not in use.
- Scroll to **Answering sys**, and then press **SELECT**.
- Scroll to **ANS ON/off**, and then press **SELECT** twice.
- Scroll to choose **On or Off**, and then press **SELECT** to save. You hear a confirmation tone.

Default announcement

The telephone is preset with a greeting that answers calls with *“Hello, please leave a message after the tone.”* You can use this preset announcement, or replace it with your own.

Record your own announcement

The announcement can be up to 90 seconds in length.

- Press **MENU** when the handset is not in use.
- Scroll to **Answering sys** and then press **SELECT** twice.
- The screen displays **Play [2]. Del [3]. Rec [7]**, and it announces, *“To play, press 2. To record, press 7.”*
- Press **7** to record. The handset announces, *“Record after the tone. Press 5 when you are done.”* After the tone, speak towards the handset microphone.
- Press 5 when done.

Play the announcement

- Press **MENU** when the handset is not in use.
- Scroll to **Answering**